



## Detached Garages and Accessory Buildings Information Supplement

9921-100 Street, Box 420, Sexsmith, AB T0H 3C0

Phone: 780-568-0215 Fax: 780-568-2200

www.sexsmith.ca/assistcao@sexsmith.ca

Permit Number: **PRBD**

Roll Number:

The following information is to **accompany** the **Building Permit Application**. This information is the minimum that is required for a garage permit application. This form may be used in lieu of providing a detailed package of drawings provided the building is a typical single storey storage garage or accessory building.

Is the building a "package"? ☐ Yes or ☐ No

If **yes**, the supplier is \_\_\_\_\_

### Construction Details:

The Roof:

Roofing Material: \_\_\_\_\_

Roof Sheathing: \_\_\_\_\_

☐ Rafters \_\_\_\_ x \_\_\_\_ or ☐ Engineered Trusses

Spacing: \_\_\_\_\_

Insulation (min. R-34 required if heated): \_\_\_\_\_

Vapour Barrier (6 mil poly required if heated): \_\_\_\_\_

Ceiling Material (1/2" CD or SR gyproc if insulated): \_\_\_\_\_

Ceiling Joists: \_\_\_\_\_

Spacing: \_\_\_\_\_

The Walls:

Exterior Finish: \_\_\_\_\_

**Note: Exterior to be weatherproof complete with flashing over all changes in material.**

☐ Sheathing Paper Sheathing: \_\_\_\_\_

☐ Double Top Plate/Single Bottom Plate

Studs: \_\_\_\_\_ Spacing: \_\_\_\_\_

Anchoring: \_\_\_\_\_

Insulation (min. R-12 required if heated): \_\_\_\_\_

Vapour Barrier (6 mil poly required if heated): \_\_\_\_\_

Interior Finish (1/2" drywall if insulated): \_\_\_\_\_

**Note: If wall height exceeds 3.0m (10') engineering is required.**

Overhead Door Size: \_\_\_\_\_

Header Size: \_\_\_\_\_

**Note: A swinging walk-in door is required.**

The Foundation:

☐ Compacted granular fill

Please select **one** of the following:

- ☐ 4" Concrete Slab - thickened on edges (**Maximum 592 sqft without engineering**)
- ☐ Pile and Grade Beam (**Engineering Required**)
- ☐ Strip Footing & 4' Pony Wall

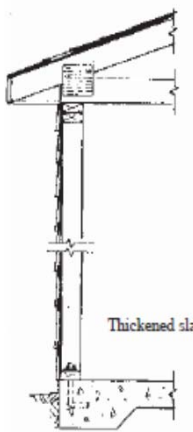

Thickened slab foundation

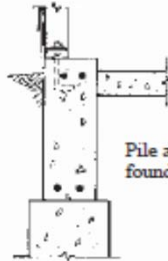

Pile and grade beam foundation.

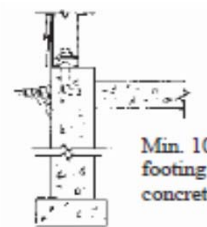

Min. 10' wide x 6' high strip footing with min. 6' thick concrete walls.

Floor Plan /  
Elevations:

This section may be completed if your garage is a typical garage resembling these drawings. If the building does not resemble these drawings, please submit detailed drawings. Note: Floor plan should be at a minimum scale of 1:100.

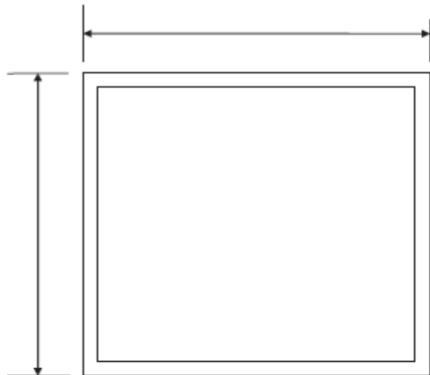

Left, please complete the following information:

- Provide outside dimensions of building.
- Show all doors and windows.
- Show orientation of trusses.
- Show any interior partitioning, together with a description of the rooms.

Below, please complete the following information:

- Label each elevation (North, South, East, West).
- Show doors and window sizes on all elevations.
- Indicate height of walls.
- Indicate slope of roof (ie. 1 in 3).

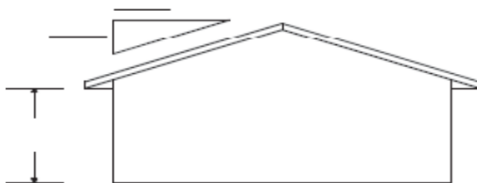

\_\_\_\_\_ Elevation

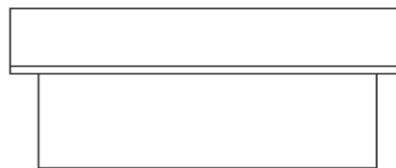

\_\_\_\_\_ Elevation

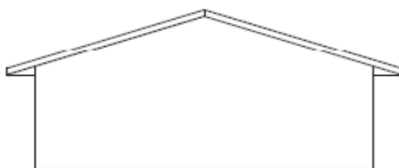

\_\_\_\_\_ Elevation

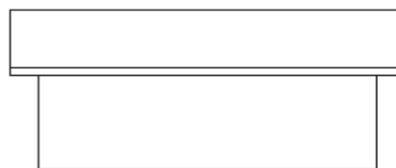

\_\_\_\_\_ Elevation